

AÉROSTAT F27  
Guillaume Delvigne



:FABBIAN



Established in the Venetian countryside in 1961, Fabbian is one of the premier Italian lighting manufacturers operating in the modern design market with the design and manufacturing of lighting fixtures for commercial, residential, and custom needs. This rich history, combined with traditional Italian craftsmanship and the finest quality materials, keeps Fabbian a prominent brand internationally recognized in the architectural and design communities worldwide.

Fabbian continues to innovate by continuously researching new materials, finishes, styles, and aesthetics. Fabbian's factory is based in the Veneto region of Italy, and it has access to a vast network of local glass and metal artisans to ensure that the highest quality expectations and safety requirements are met.

# AÉROSTAT F27

Guillaume Delvigne



## Quick Links

[Cable Mount Pendant Selection](#)

[Rod Mount Pendant Selection](#)

[Wall/Ceiling Selection](#)

[Table Lamp Selection](#)

[Pendant Lights with Metal Base Selection](#)

[Table Lamp with Metal Base Selection](#)

[Floor Lamp with Metal Base Selection](#)







Since its launch, F27 Aérostat has been favored by designers for its unique diffuser shape reminiscent of a contemporary schoolhouse design style. The Guillaume Delvigne designed collection offers universal appeal to both modern and more traditional design styles.

Aérostat is a complete collection including pendants, wall/ceiling fixtures, table and floor lamps, all realized with glossy white blown glass and offered with or without metal base. Aérostat's range of types and lamp choices make this a go to collection for residential and commercial projects.



Aérostat is a complete and versatile collection with 120V "off the rack" fixtures for retail and residential customers and Made-to-Spec possibilities for commercial specifiers needing more options. Made-to-Spec allows users to specify glass size, suspension/mounting type and color, lamp type, power supplies, and color temperatures (for LED) to create the perfect custom combination using standard components.

Aérostat offers versatility with a selection of lamp types, including socket-based 120V, 120V LED with integral drivers and dim-to-warm capabilities, and High-Performance 120-277V LED models with dimming driver options.

Aérostat, in all its forms, offers solutions for residential, hospitality, retail, restaurant, corporate, healthcare, and educational installations.



Table lamps with metal base, and classic pendant



Aérostat's blown glass diffusers are masterfully crafted pieces that exemplify artistry and precision. At the heart of each diffuser lies a glob of molten glass, meticulously shaped into a round form by skilled artisans. This initial shaping involves the addition of multiple layers of glass, which creates the solid white color that evenly diffuses the light.

The glass-blowing technique employed is a spinning mold method, which enhances the symmetry and quality of the glass. As the glassblower, or Gaffer, works, they expertly manipulate the glass by blowing and rotating it, allowing the material to assume the desired size and shape. This process relies on a centrifugal force, which contributes to the uniformity of the final product.

This meticulous craftsmanship not only ensures that each diffuser is unique but also that it meets Fabbian's high standards for quality and aesthetic appeal. The result is a stunning piece that combines beauty with functionality, ready to illuminate any space with elegance.









## AÉROSTAT

Aérostat are offered in two forms, the classic schoolhouse globe or with a modern metal cage accent- blending vintage looks with modern accents. Both forms offering quality craftsmanship and evenly diffused illumination.

The classic globe is offered in three sizes, cord or rod suspension, with choice of incandescent, 120V LED, 120V Dim to Warm LED, and High-Performance 120V-277V configurable LED lamp types. The metal cage version are offered in two sizes, three finishes, with incandescent lamping.



## Modern Schoolhouse Pendant Lights



Aérostat classic schoolhouse globe-shaped pendants are available as cable or rod mount, 120V socket-based fixtures, 120V LED LED/ELV dimming models with integral drivers, and High-Performance 120-277V LED configurable models using remote dimming driver options.

### How to Choose:

#### Socket Based Fixtures

- A socket-based fixture can illuminate the globe with any lamp (LED, Incandescent, RGB, etc.), select for maximum flexibility and cost-effective solutions.
- Dimming is lamp selection dependent.
- Use cases: Residential and restaurant applications or for applications allowing for lower levels of lighting or lamp tones not available as standard such as 2400K, 5000K or RGB.

#### 120V LED

- The 120V LED option is available for globes over 12" and offers a 3000K or Dim-to-Warm LED option that complies with lighting and energy codes for most commercial applications.
- 120V LED is simple to wire and dim with the driver built into the LED Module. 17W 1850 lumens 3000K, dimmable via line voltage (LED Triac or ELV dimmer) or 17W 1307 lumens 3000K to 1800K Dim to Warm, dimmable via line voltage (LED Triac or ELV dimmer).
- Use cases: Commercial and residential applications where 3000K CCT or 3000K to 1800K is appropriate

#### High-Performance LED

- High-Performance LED (HP LED) options are the premiere specification product for every commercial application. HP LED options are available for the 12.9" and 16.8" Aérostat pendants.
- The HP LED Modules provide a powerful 2365 lumens for highly efficient illumination options, in a range of color temperatures (2700K to 4000K) at 90+CRI.
- Our specification table lists an in-j-box mounted Universal LED Driver for 120V and 277V, and dimming via LED Triac dimmer, ELV, or 0-10V options. Additional options for remote low-voltage wiring and advanced dimming through integration with DALI and Lutron control systems are available.
- HP LED pendants (over 12") include a wipe-down cover to match the selected finish color (White, Black, Gold, and Copper)
- Use cases: Residential, hospitality, restaurants, healthcare, office/corporate, retail, cultural, locations with specific CCT requirements.



# Cable Mount Pendant Selection

To specify a fixture, select the size and choose from the available options listed below.

Lamp-based and Standard LED fixtures use a single-part number assembly, as shown.

Dim to Warm LED fixtures are configured from (2) components (Hardware, and Glass) listed. To complete the fixture, specify the hardware finish code for XX: White (01), Black (02), Painted Gold (12), and Painted Copper (41).

High-Performance LED fixtures are configured from the (3) components (Hardware, Glass, and Driver) listed. To complete the fixture, specify the hardware finish code for XX: White (01), Black (02), Painted Gold (12), and Painted Copper (41).

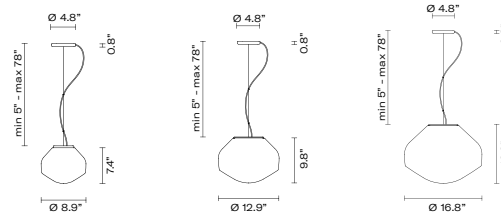

Alternate advanced LED driver options are listed below if required.

		Small Glass		
		Ø8.9	Ø12.9	Ø16.8
<b>120V Lamp-Based Pendant</b>	Lamp Spec by Others	N/A	F27 A07A 01	F27 A09A 01
Small Glass - G9 Socket, 50W Max Lamp Large Glass - E26 Socket, 150W Max Lamp				
<b>120V Integral LED Pendant</b>	<b>3000K, 80CRI</b>	F27 A01A 01	F27 A03A 01	F27 A05A 01
17W, 1850 Lumens, 3000K, CRI>80 LED, ELV Dimming				
<b>120V Integral LED Pendant - Configurable</b>	<b>3000K, 80CRI</b>	N/A	F07A35S A 01 F27A03V 01 Glass	F07A35S A 01 F27A05V 01 Glass
17W, 1850 Lumens, 3000K, CRI>80 LED, ELV Dimming				
<b>120V Integral Dim to Warm LED Pendant</b>	<b>3000K to 1800K, 90+CRI</b>	N/A	F07A95S A 01 F27A03V 01 Glass	F07A95S A 01 F27A05V 01 Glass
17W, 1307 Lumens, 3000K to 1800K, CRI 90+ LED, TRIAC/ELV Dimming				
<b>High Performance (HP) 24V LED Fixtures</b>	<b>2700K, 90+CRI</b>	N/A	F66L11SA XX F27A03V 01 Glass A55211 Driver	F66L11SA XX F27A05V 01 Glass A55211 Driver
	<b>3000K, 90+CRI</b>	N/A	F66L12SA XX F27A03V 01 Glass A55211 Driver	F66L12SA XX F27A05V 01 Glass A55211 Driver
	<b>3500K, 90+CRI</b>	N/A	F66L13SA XX F27A03V 01 Glass A55211 Driver	F66L13SA XX F27A05V 01 Glass A55211 Driver
	<b>4000K, 90+CRI</b>	N/A	F66L14SA XX F27A03V 01 Glass A55211 Driver	F66L14SA XX F27A05V 01 Glass A55211 Driver
120V/277V Integral LED 0-10V, ELV, & Triac Dimming				
Small Glass - 7W, 900 Lumens Large Glass - 20W, 2365 Lumens				

**LED Drivers for HP LED Fixtures:**

LED Drivers for in Junction Box Applications  
A55211 - 25W, 24VDC Class 2 LED Driver. 120-277V Input. Triac, ELV, and 0-10V dimming. Fits in J-box Above Fixture. Supports 2 Small or 1 Large Fixtures.

LED Drivers for Remote-Mount Applications  
Substitute the A55211 Driver with one of the following options or an Advanced 24V DC LED Driver by others for DALI or Lutron Integration.  
A55210 - 96W, 24VDC Class 2 LED Driver. 120-277V Input. 0-10V Dimming. Remote Mount Only. Supports 12 Small or 4 Large Fixtures.  
A55209 - 96W, 24VDC Class 2 LED Driver. 120V Input. ELV Dimming. Remote Mount Only. Supports 12 Small or 4 Large Fixtures.  
A55208 - 60W, 24VDC Class 2 LED Driver. 120V Input. ELV Dimming. Remote Mount Only. Supports 8 Small or 3 Large Fixtures.



## Rod Mount Pendant Selection

To specify a fixture, select the size and choose from the available options listed below.

120V LED fixtures are configured from (2) components (Hardware, and Glass) listed. To complete the fixture, specify the hardware finish code for XX: White (01), Black (02), Painted Gold (12), and Painted Copper (41).

High-Performance LED fixtures are configured from the (3) components (Hardware, Glass, and Driver) listed. To complete the fixture, specify the hardware finish code for XX: White (01), Black (02), Painted Gold (12), and Painted Copper (41).

Alternate advanced LED driver options are listed below if required.

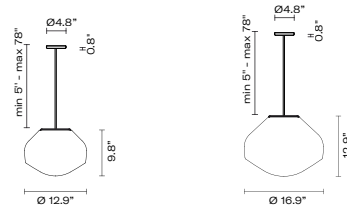

		Large Glass	
		Ø12.9	Ø16.8
<b>120V Integral LED Pendant</b>	<b>3000K, 80CRI</b>	F07 A62SA XX F27A03V 01 Glass	F07 A62SA XX F27A05V 01 Glass
17W, 1307 Lumens, 3000K, CRI 90+LED, TRIAC/ELV Dimming			
<b>120V Integral Dim to Warm LED Pendant</b>	<b>3000K to 1800K, 90+CRI</b>	F07 A61SA XX F27A03V 01 Glass	F07 A61SA XX F27A05V 01 Glass
17W, 1307 Lumens, 3000K to 1800K, CRI 90+ LED, TRIAC/ELV Dimming			
<b>High Performance (HP) 24V LED Fixtures</b>	<b>2700K, 90+CRI</b>	F66L71SA XX F27A03V 01 Glass A55211 Driver	F66L71SA XX F27A05V 01 Glass A55211 Driver
	<b>3000K, 90+CRI</b>	F66L72SA XX F27A03V 01 Glass A55211 Driver	F66L72SA XX F27A05V 01 Glass A55211 Driver
	<b>3500K, 90+CRI</b>	F66L73SA XX F27A03V 01 Glass A55211 Driver	F66L73SA XX F27A05V 01 Glass A55211 Driver
	<b>4000K, 90+CRI</b>	F66L74SA XX F27A03V 01 Glass A55211 Driver	F66L74SA XX F27A05V 01 Glass A55211 Driver
120V/277V Integral LED 0-10V, ELV, & Triac Dimming  Large Glass - 20W, 2365 Lumens			

### LED Drivers for HP LED Fixtures:

#### LED Drivers for in Junction Box Applications

A55211 - 25W, 24VDC Class 2 LED Driver. 120-277V Input. Triac, ELV, and 0-10V dimming. Fits in J-box Above Fixture. Supports 2 Small or 1 Large Fixtures.

#### LED Drivers for Remote-Mount Applications

Substitute the A55211 Driver with one of the following options or an Advanced 24V DC LED Driver by others for DALI or Lutron Integration.

A55210 - 96W, 24VDC Class 2 LED Driver. 120-277V Input. 0-10V Dimming. Remote Mount Only. Supports 12 Small or 4 Large Fixtures.

A55209 - 96W, 24VDC Class 2 LED Driver. 120V Input. ELV Dimming. Remote Mount Only. Supports 12 Small or 4 Large Fixtures.

A55208 - 60W, 24VDC Class 2 LED Driver. 120V Input. ELV Dimming. Remote Mount Only. Supports 8 Small or 3 Large Fixtures.





## Wall/Ceiling Lights

Aérostat schoolhouse globe-shaped wall/ceiling lights are available as 120V socket-based fixtures, 120V LED LED/ELV dimming models with integral drivers, and High-Performance 120-277V LED configurable models using remote dimming driver options.

### How to Choose:

#### Socket Based Fixtures

- A socket-based fixture can illuminate the globe with any lamp (LED, Incandescent, RGB, etc.), select for maximum flexibility and cost-effective solutions.
- Dimming is lamp selection dependent.
- Use cases: Residential and restaurant applications or for applications allowing for lower levels of lighting or lamp tones not available as standard such as 2400K, 5000K or RGB.

#### 120V LED

- The 120V LED option is available for globes over 12" and offers a 3000K or Dim-to-Warm LED option that complies with lighting and energy codes for most commercial applications.
- 120V LED is simple to wire and dim with the driver built into the LED Module. 17W 1850 lumens 3000K, dimmable via line voltage (LED Triac or ELV dimmer) or 17W 1307 lumens 3000K to 1800K Dim to Warm, dimmable via line voltage (LED Triac or ELV dimmer).
- Use cases: Commercial and residential applications where 3000K CCT or 3000K to 1800K is appropriate

#### High-Performance LED

- High-Performance LED (HP LED) options are the premiere specification product for every commercial application. HP LED options are available for the large sizes of Aérostat.
- The HP LED Modules provide a powerful 900 lumens (small glass) and 2365 lumens (large glass) for highly efficient illumination options, in a range of color temperatures (2700K to 4000K) at 90+CRI.
- Our specification table lists an in-j-box mounted Universal LED Driver for 120V and 277V, and dimming via LED Triac dimmer, ELV, or 0-10V options. Additional options for remote low-voltage wiring and advanced dimming through integration with DALI and Lutron control systems are available
- Use cases: Residential, hospitality, restaurants, healthcare, office/corporate, retail, cultural, locations with specific CCT requirements.



## Wall/Ceiling Selection

To specify a fixture, select the size and choose from the available options listed below.

Lamp-based and Standard LED fixtures use a single-part number assembly, as shown.

Dim to Warm LED fixtures are configured from (2) components (Hardware, and Glass) listed. To complete the fixture, specify the hardware finish code for XX: White (01), Black (02), Painted Gold (12), and Painted Copper (41).

High-Performance LED fixtures are configured from the (3) components (Hardware, Glass, and Driver) listed. To complete the fixture, specify the hardware finish code for XX: White (01), Black (02), Painted Gold (12), and Painted Copper (41).

Alternate advanced LED driver options are listed below if required.

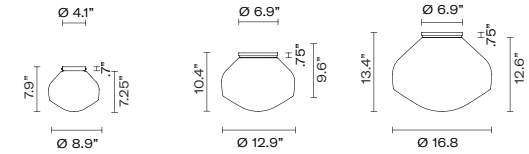

		Small Glass	Large Glass	
		Ø8.9	Ø12.9	Ø16.8
<b>120V Lamp-Based Fixture</b> Small Glass - G9 Socket, 50W Max Lamp Large Glass - E26 Socket, 150W Max Lamp	Lamp Spec by Others	N/A	F27 G07A 01	F27 G09A 01
<b>120V Integral LED Fixture</b> 17W, 1850 Lumens, 3000K, CRI>80 LED, ELV Dimming	<b>3000K, 80CRI</b>	F27 G01A 01	F27 G03A 01	F27 G05A 01
<b>120V Integral LED Fixture - Configurable</b> 17W, 1850 Lumens, 3000K, CRI>80 LED, ELV Dimming	<b>3000K, 80CRI</b>	N/A	F07A21V01 F27A03V 01 Glass	F07A21V01 F27A05V 01 Glass
<b>120V Integral Dim to Warm LED Fixture</b> 17W, 1307 Lumens, 3000K to 1800K, CRI 90+ LED, TRIAC/ELV Dimming	<b>3000K to 1800K, 90+CRI</b>	N/A	F07E95S A 01 F27A03V 01 Glass	F07E95S A 01 F27A05V 01 Glass
<b>High Performance (HP) 24V LED Fixtures</b> 120V/277V Integral LED 0-10V, ELV, & Triac Dimming  Small Glass - 7W, 900 Lumens Large Glass - 20W, 2365 Lumens	<b>2700K, 90+CRI</b>	N/A	F66G11SA XX F27A03V 01 Glass A55211 Driver	F66G11SA XX F27A05V 01 Glass A55211 Driver
	<b>3000K, 90+CRI</b>	N/A	F66G12SA XX F27A03V 01 Glass A55211 Driver	F66G12SA XX F27A05V 01 Glass A55211 Driver
	<b>3500K, 90+CRI</b>	N/A	F66G13SA XX F27A03V 01 Glass A55211 Driver	F66G13SA XX F27A05V 01 Glass A55211 Driver
	<b>4000K, 90+CRI</b>	N/A	F66G14SA XX F27A03V 01 Glass A55211 Driver	F66G14SA XX F27A05V 01 Glass A55211 Driver

### LED Drivers for HP LED Fixtures:

LED Drivers for in Junction Box Applications  
A55211 - 25W, 24VDC Class 2 LED Driver. 120-277V Input. Triac, ELV, and 0-10V dimming. Fits in J-box Above Fixture. Supports 2 Small or 1 Large Fixtures.

LED Drivers for Remote-Mount Applications  
Substitute the A55211 Driver with one of the following options or an Advanced 24V DC LED Driver by others for DALI or Lutron Integration.  
A55210 - 96W, 24VDC Class 2 LED Driver. 120-277V Input. 0-10V Dimming. Remote Mount Only. Supports 12 Small or 4 Large Fixtures.  
A55209 - 96W, 24VDC Class 2 LED Driver. 120V Input. ELV Dimming. Remote Mount Only. Supports 12 Small or 4 Large Fixtures.  
A55208 - 60W, 24VDC Class 2 LED Driver. 120V Input. ELV Dimming. Remote Mount Only. Supports 8 Small or 3 Large Fixtures.



## Table Lamps

Aérostat table lamps provide generous amounts of evenly diffused illumination. The glass is offered in 2 sizes and incandescent or LED lamp types. Use the lamps individually or create groupings of different sizes. 120V lamp cords come with inline on/off switches and LED models are dimmable with an LED or ELV wall dimmer.

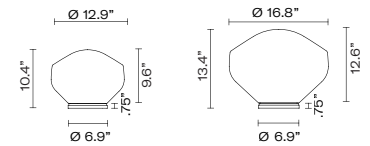

		Ø12.9	Ø16.8
<b>120V Lamp-Based Fixture</b> Small Glass - G9 Socket, 20W or 50W Max Lamp Large Glass - E26 Socket, 150W Max Lamp	Lamp Spec by Others	F07B05S A 01 F27A03V 01 Glass	F07B05S A 01 F27A05V 01 Glass
		<b>120V Integral LED Fixture</b> 17W, 1850 Lumens, 3000K, CRI>80 LED, ELV Dimming	<b>3000K, 80CRI</b>











## Globe with Metal Base Pendant Lights

Aérostat with metal base pendants are available as cable suspended pendants that use 120V socket-based light sources. Pendants are offered in two sizes with choice of brass, black chrome, or copper plated metal finishes.

### Socket Based Fixtures Details

- A socket-based fixture can illuminate the globe with any lamp (LED, Incandescent, RGB, etc.), select for maximum flexibility and cost-effective solutions.
- Dimming is lamp selection dependent.
- Use cases: Residential and restaurant applications or for applications allowing for lower levels of lighting or lamp tones not available as standard such as 2400K, 5000K or RGB.

### Globe with Metal Base Pendant Selection

To specify a fixture, select the size and choose from the available options listed below.

Lamp-based fixtures use a single-part number assembly, as shown.

To complete the fixture, specify the hardware finish code for XX: Brass Plated (19), Black Chrome (24), or Copper Plate (41).

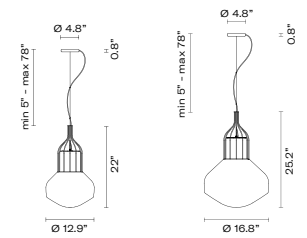

		Large Glass	
		Ø12.9	Ø16.8
<b>120V Lamp-Based Pendant</b>	Lamp Spec by Others	F27 A11A XX	F27 A13A XX
Large Glass - E26 Socket, 150W Max Lamp			







## Table Lamp with Metal Base

Aérostat with metal base table lamps are available with 120V socket-based light sources. Lamps are offered in two sizes with choice of brass, black chrome, or copper plated metal finishes.

### Socket Based Fixtures Details

- A socket-based fixture can illuminate the globe with any lamp (LED, Incandescent, RGB, etc.), select for maximum flexibility and cost-effective solutions.
- Dimming is lamp selection dependent.
- Use cases: Residential and restaurant applications or for applications allowing for lower levels of lighting or lamp tones not available as standard such as 2400K, 5000K or RGB.

### Table Lamp with Metal Base Selection

To specify a fixture, select the size and choose from the available options listed below.

Lamp-based fixtures use a single-part number assembly, as shown.

To complete the fixture, specify the hardware finish code for XX: Brass Plated (19), Black Chrome (24), or Copper Plate (41).

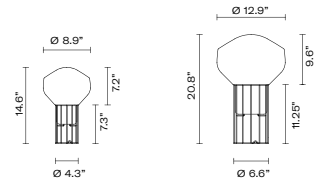

		Large Glass	
		Ø8.9	Ø12.9
<b>120V Lamp-Based Pendant</b> Large Glass - E26 Socket, 150W Max Lamp	Lamp Spec by Others	F27 B01A XX	F27 B03A XX









### Floor Lamp with Metal Base

Aérostat with metal base floor lamps are available with 120V socket-based light sources. Lamps are offered in two sizes with choice of brass, black chrome, or copper plated metal finishes.

#### Socket Based Fixtures Details

- A socket-based lamp can illuminate the globe with any lamp (LED, Incandescent, RGB, etc.), select for maximum flexibility and cost-effective solutions.
- Dimming is lamp selection dependent.
- Use cases: Residential and restaurant applications or for applications allowing for lower levels of lighting or lamp tones not available as standard such as 2400K, 5000K or RGB.

### Floor Lamp with Metal Base Selection

To specify a fixture, select the size and choose from the available options listed below.

Lamp-based fixtures use a single-part number assembly, as shown.

To complete the fixture, specify the hardware finish code for XX: Brass Plated (19), Black Chrome (24), or Copper Plate (41).

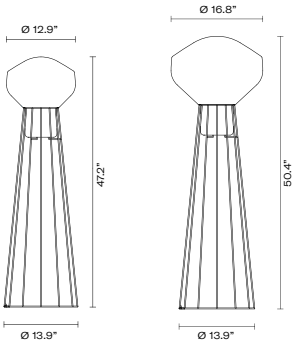

		Large Glass	
		Ø12.9	Ø16.8
<b>120V Lamp-Based Pendant</b> Large Glass - E26 Socket, 150W Max Lamp	Lamp Spec by Others	F27 C01A XX	F27 C03A XX



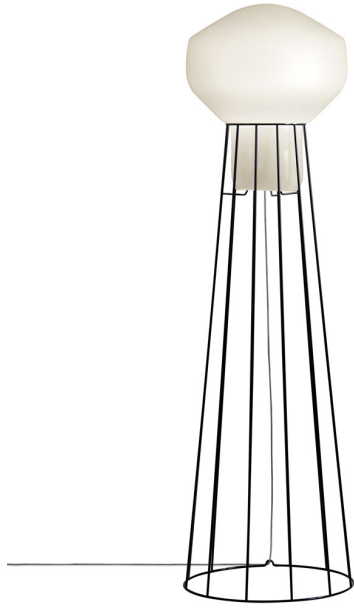



TECHNICAL





## Pendant Details



### Larger Pendants (12"+)

- Glass fitter equipped with leveling mechanism
- Cables can be bound together with the included clear bands
- Eliminates long balancing rod atop

## Installation Notes for Larger Pendants (12"+)

The larger Aérostat pendants can be installed with the electrical wire pulled straight or swagged along the cable.



## Wipe-down Top Cover for High Performance Pendants

- For healthcare and view from above installations
- Included as standard component with High Performance models 12" and larger
- Available in white, black, copper and gold to match fixture hardware



### DECENTRALIZATION KIT

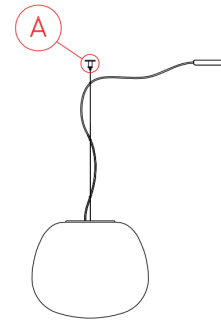

### Offset Pendant Mounting

- Offset mounting hardware is included with pendants, which have a separate support cable that allows the j-box to be located away from the fixture.
- Hardware can be used with or



### Benefits

Simplifies installation for the following conditions:

- Sloped ceiling installations
- Through ceiling installations (i.e. Slatted ceilings)
- Single J-box can now feed multiple pendants
- If power is in a non-visible area, no canopy to manage



## Rod Mount Pendant Details

Rod mounting is offered for pendants using 12" in diameter or larger glass

- For applications requiring additional stability, such as locations near vents, areas with seismic activity, or simply for aesthetic preferences
- Rod mount include glass fitting, lighting components, and canopy. Rod and canopy assembly are 60 inches tall and can be field cut to size
- Offered in four standard finishes, painted white, black, gold, or copper



Finishes

Aérostat Made-to-Spec  
Standard painted finishes



Painted textured White - 01



Painted textured Black - 02



Painted Gold - 12



Painted Copper - 41

Aérostat with Metal Base  
Standard plated finishes



Plated Brass - 19



Plated Black Chrome - 24



Plated Copper - 41

















[fabbian.us](https://fabbian.us)

